

LD Flexi

IP68 Flexible 24V Linear LED



Data sheet - Page 1



LD Flexi is a robust, very shallow, IP68 rated flexible 24V linear LED product. Ideal for a range of architectural applications that include steps and underwater details.

Please note colour shift: Due to the resin being in contact with the LED there is a colour shift of around 600K to a cooler white colour temperature. This means the warmest white we can supply is 3300K which uses 2700K LED tape.

Key Features

- Choice of LED outputs depending on the application, including RGB
- Specially designed PVC extrusion which is robust but very flexible with excellent resistance to chemical attack
- LEDs are encapsulated in an optically clear UV resistant polyurethane resin
- Fixing is by stainless steel fixing clips, with a choice of two depending on the installation detail
- LD Flexi only bends in the vertical plane (around the thinnest side), to a minimum bend radius of 200mm
- IP68 rated for underwater applications
- Lengths are custom made to suit to a maximum of 3015mm**
- Available with Switched, 1-10V, DMX or Dali drivers

Dimensions

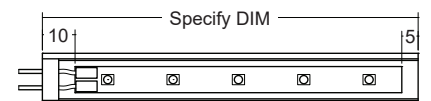
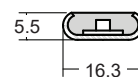

(Dimensions in mm)



LD Flexi



IP68 Flexible 24V Linear LED

Data sheet - Page 2

LED output options	Eco 220 lm/m		Short 780 lm/m		RGB 435 lm/m
Applications					
	<p>Highlighting architectural details, steps</p>		<p>Same applications as Eco but with increased output and closer pitch LEDs</p>		<p>Colour change</p>
Description	Eco output tape		Short pitch tape		RGB tape
Colour Temperature*	3300K (2700K)*	4600K (4000K)*	3300K (2700K)*	5600K (5000K)*	-
Delivered lumens / m	220lm/m	240lm/m	780lm/m	850lm/m	435lm/m
Watts / m	3.6W/m		9.7W/m		18W/m
Lumens per watt	61lm/w		80lm/w		-
Voltage (V)	24V DC				
CRI	85				-
LED	Osram Flex				
LED cut increments	100mm		50mm		100mm
LED spacing	20mm		8.3mm		25mm
Min single length	113mm		63mm		115mm
Max single length**	3015mm				
LED lifetime	50,000hrs (to 70% lumen output)				
Max ambient temperature	45°C				30°C
Minimum bend radius	200mm				
Materials	LD Flexi - PVC extrusion, polyurethane resin, polycarbonate end cap. Fixing clips - stainless steel.				
Cable length	2m (can be specified with up to 10m at extra cost)				
IP rating	IP68				

* 3300K Eco and Short uses 2700K LED, 4600K Eco uses 4000K LED and 5600K Short uses 5000K LED due to the colour shift caused by the resin

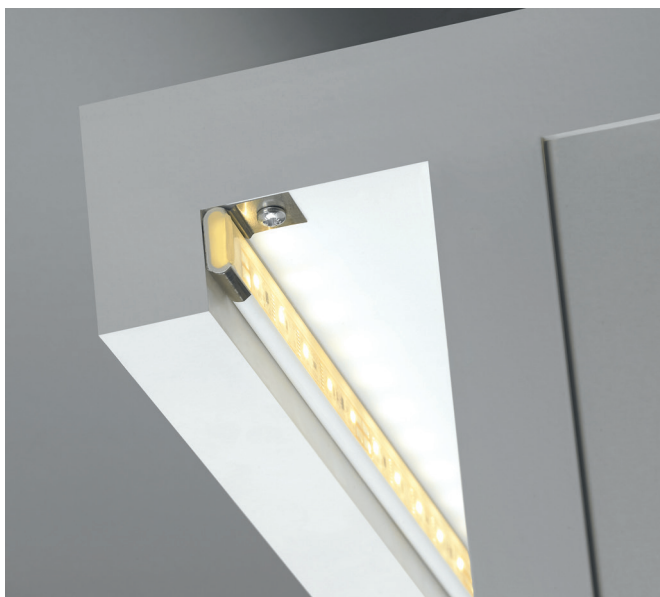

Fixing options

/FFC - Flat fixing clip

/AFC - Angled fixing clip

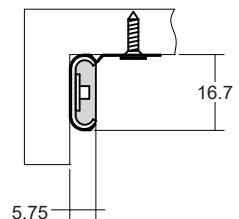
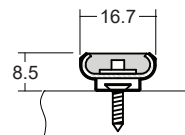
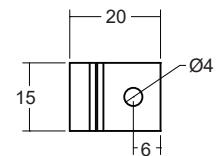
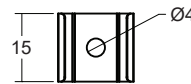

(Dimensions in mm)

LD Flexi

IP68 Flexible 24V Linear LED



Data sheet - Page 3

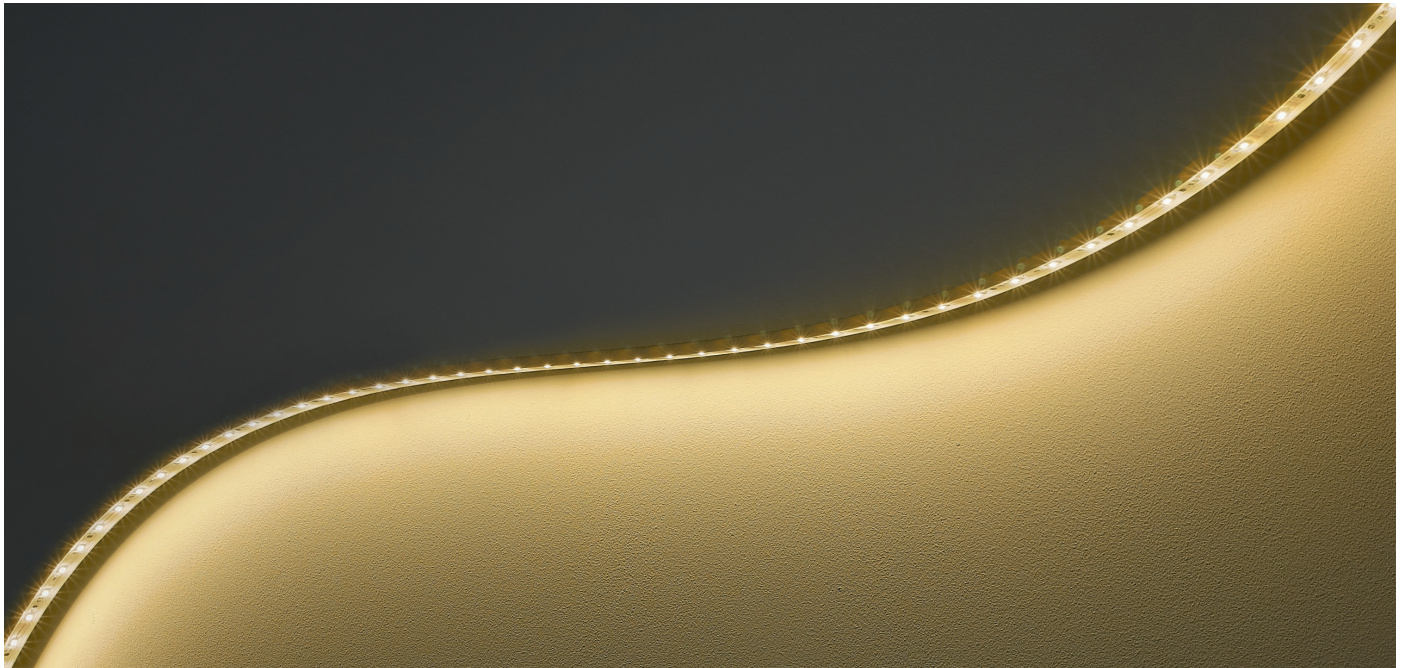

Suggested mounting details

We recommend the distances shown below when mounting multiple lengths end to end to ensure a continuous wash of light.

Angled fixing clip

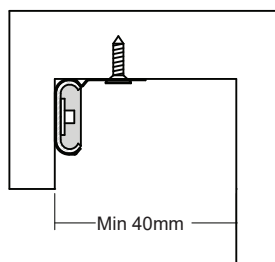

Flat fixing clip

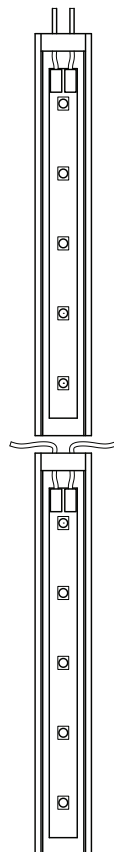
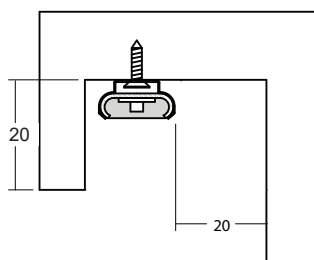

Photometrics

Photometric files are included in the design pack which can be downloaded from the LD Flexi product page on the website.

Order Codes and Options

Product code	LED	LED colour	Fixing option	Length
LD Flexi	<input type="text"/>	<input type="text"/>	<input type="text"/>	<input type="text"/>

Example: LDFlexi / Eco / LW33 / AFC / 2000mm

LED output options	Suffix
Eco	/Eco
Short	/Short
RGB	/RGB
LED colour options	
Warm White (3300K)	/LW33
Cool White (4600K Eco)	/LW46
Cool White (5600K Short)	/LW56
Fixing options	
Angled fixing clip	/AFC
Flat fixing clip	/FFC
(3 fixing clips supplied per metre)	
To be used with 24V constant voltage LED Drivers and Controllers	
We offer a range of drivers with 1-10V, DMX, and DALI dimming options. Please download the data sheet from the downloads section at www.lightgraphix.co.uk , or contact us for more information	